

# Sustainable Buildings & Construction Summit



## Information for Participants

### Sustainable Buildings and Construction Summit 2026

- Dates:** April 20–22, 2026
- Location:** Lausanne, Switzerland

#### 1. Summit Overview

The [Sustainable Buildings and Construction Summit 2026](#) convenes government officials alongside academics, private sector leaders, financiers, and civil society—converging policymakers, researchers, and practitioners. Co-organised by **EPFL and the UNEP-hosted Global Alliance for Buildings and Construction (GlobalABC)** secretariat, the Summit builds on the success of the first [Global Forum on Buildings and Climate](#) held in Paris in 2024.

Focusing on emerging markets and developing economies where built environment growth is most significant, the Summit will translate global sustainability commitments into practical solutions. The programme includes an **Intergovernmental Council for Buildings and Climate (ICBC) technical meeting**, cross-disciplinary workshops, academic showcases, and solution-focused roundtables for more than 800 practitioners expected.

The Summit's key deliverables are an outcome paper and a compendium of solutions. To encourage candid dialogue, sessions will not be recorded or livestreamed.

For further information, please contact [contact@sustainable-construction.org](mailto:contact@sustainable-construction.org) and [global.abc@un.org](mailto:global.abc@un.org).

**Check-in on Day 1 will begin at 7:30am.**  
**Arrive early to avoid delays and enjoy a coffee before the proceedings begin!**

SUSTAINABLE BUILDINGS & CONSTRUCTION SUMMIT 2026 SPONSORS



ARUP

AUTODESK



Sinoma 中材建设有限公司  
CBMI Construction Co., Ltd.

DAIKIN

Heidelberg  
Materials

HOLCIM

RICS

SAINT-GOBAIN

Schweizerische Eidgenossenschaft  
Confédération suisse  
Confederazione Svizzera  
Confederaziun svizra  
  
Swiss Agency for Development  
and Cooperation SDC

## 2. Venue Information: Day 1, 2 & 3



**Address:** Route Louis Favre 2, 1024 Ecublens, Switzerland  
**Google maps:** <https://maps.app.goo.gl/JSQrWnGYNuEYhU516>  
**Onsite event opening hours:** 8am – 7:30pm (day 1, 2 & 3)

### Venue Map

#### a) Auditorium room A

All plenary sessions will be on **Auditorium A**, which is accessible from the main foyer.



## b) Workshop rooms

Seminar Rooms 1, 2,4,5, 3A & 3BC are located at **level minus one**.

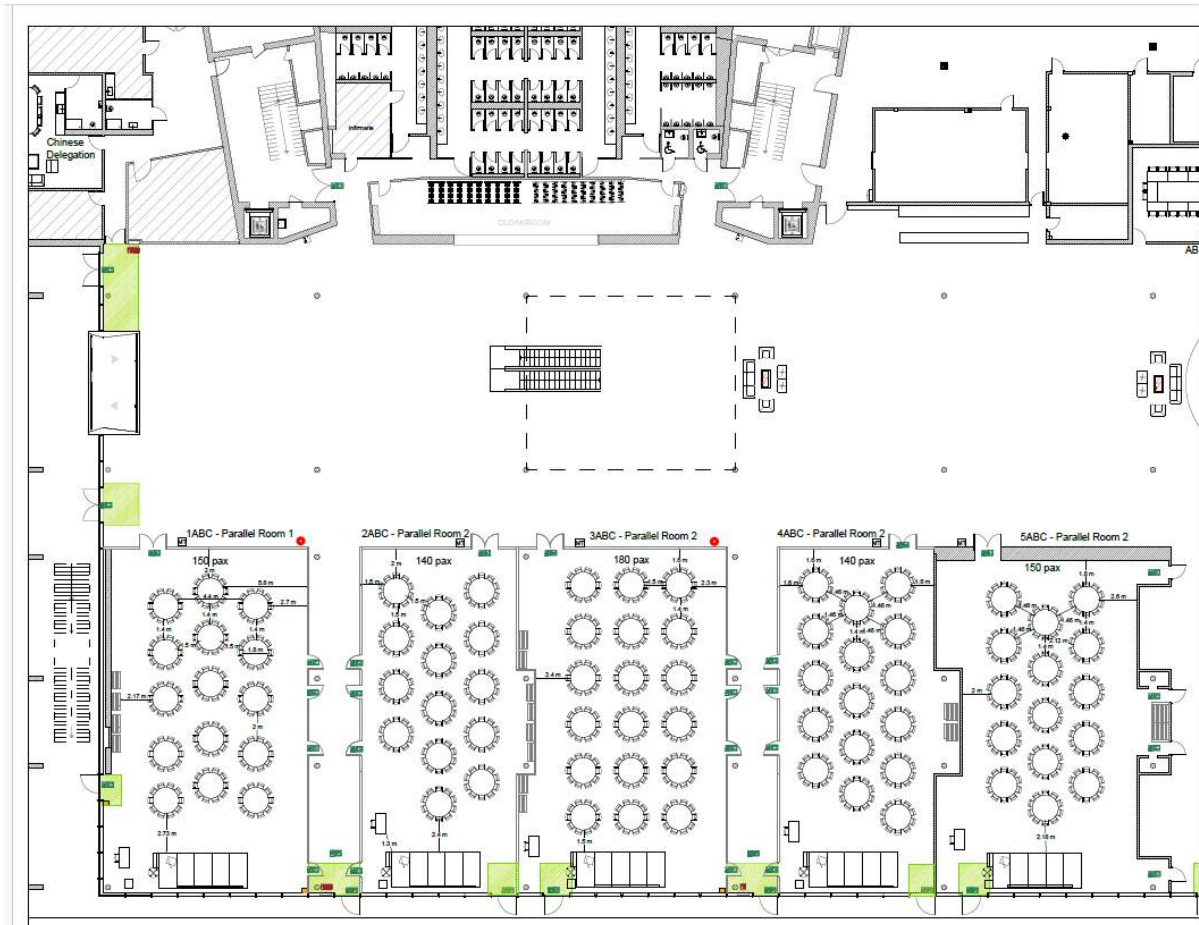

The CLOUD venue is located on **level plus one** (CLOUD level)

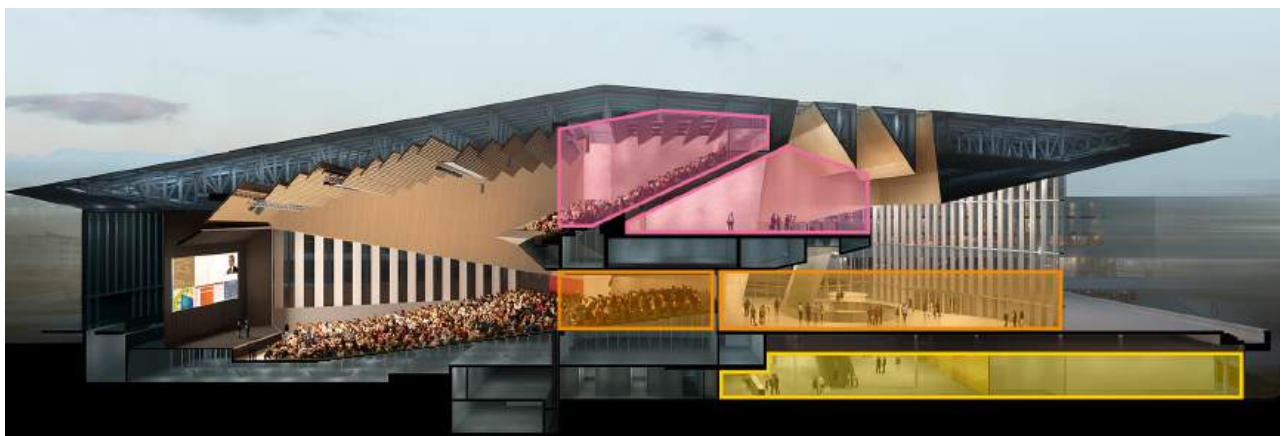

The image above shows the colour-coded locations.

### 3. Onsite Contacts and Support

| Name                 | Contact (Email)  | Title                       |
|----------------------|--|-----------------------------|
| Nyasha Harper-Michon | <a href="mailto:nyasha.harper@un.org">nyasha.harper@un.org</a>     | Communications Expert, UNEP |
| Rue Munemo           | <a href="mailto:ruvimbo.munemo@epfl.ch">ruvimbo.munemo@epfl.ch</a> | Research Associate, EPFL    |

For any logistical or emergency-related queries, please feel free to reach out to our team via WhatsApp. We have **created a WhatsApp chat group** which you can join.

**Please find the link to join here:**

[https://chat.whatsapp.com/FnxPjgyGluH1rRuUEzG5G1?mode=gi\\_t](https://chat.whatsapp.com/FnxPjgyGluH1rRuUEzG5G1?mode=gi_t)

### 4. Accommodation in Lausanne

Explore hotel options [here](#). The venue is located a few steps from the **EPFL M1 Metro** stop and all travel times are approximate to this stop.

Summit attendees can also benefit from exclusive accommodation rates offered directly by **SwissTech Hotel** and **Starling Hotel Lausanne @EPFL**.



Guests may book for the **Swisstech Hotel** by emailing to [reception@sthotel.ch](mailto:reception@sthotel.ch) with the **"SUMMIT26"** Promotional Code to access the special event rate.



For the **Starling Hotel**, guests can access access the special rate through this [specialised booking link](#).

## 🚗 Transport Options: Geneva Airport → Starling Hotel Lausanne

| Mode              | Time       | Cost        | Steps  | Best For                                      |
|-------------------|------------|-------------|--|---|
| Train             | ~1h–1h10   | CHF 25–50   | Direct train from airport → Renens VD → short metro (M1), bus, or walk | Most efficient, reliable, and balanced option |
| Taxi / Uber       | ~35–45 min | CHF 200–250 | Direct door-to-door from airport to hotel                              | Comfort, late arrivals, heavy luggage         |
| Train + Metro/Bus | ~1h10–1h20 | CHF 25–50   | Train → Lausanne or Renens → M1 metro or bus → hotel                   | Flexible route, very common in Switzerland    |

### Travel from Starling hotel to the SwissTech:

There are two ways to go and come back from the EPFL campus to Starling hotel. *The easiest way is by walking (approximately 10mins):*



## 5. Travel from Geneva Airport (nearest airport) to Lausanne

| Airport              | Address   | Distance to Lausanne | Travel time to Lausanne      | Approx. train cost to Lausanne |
|----------------------|---|----------------------|------------------------------|--------------------------------|
| Geneva Airport (GVA) | <u>Rte de l'Aéroport 21, 1215 Genève</u><br><u>15 Aéroport, Switzerland</u> | 51 km                | 45–60 minutes (direct train) | CHF 20–35 (€21–37)             |

### Other (further) option

| Airport              | Address  | Distance to Lausanne | Travel time to Lausanne | Approx. train cost to Lausanne |
|----------------------|--|----------------------|-------------------------|--------------------------------|
| Zurich Airport (ZHR) | <u>Flughafen Zürich AG, 8058 Zürich-Flughafen, Switzerland</u> | 180 – 230 km         | 2h30                    | CHF 70–80 (€76–89)             |



Convenient, quick and reliable, public transportation is probably the best way to get around in Lausanne and in Switzerland. The metro M1 can bring you to the SwissTech Convention Center from the Renens train station or the city center of Lausanne. It comes every 5 minutes and it will only take you 10 minutes to get here.

## 6. Travel from Lausanne

The SwissTech Convention center is ideally located on the EPFL Campus. The access is very easy with the **M1 EPFL Metro Stop** right at the venues door steps. Wherever you are, you will find an easy access to our meeting center.

The center is also accessible for people with reduced mobility.

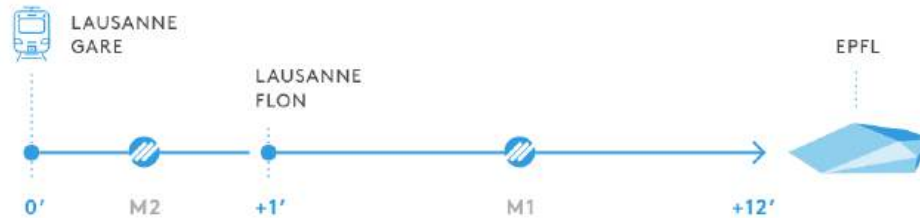

Located in the centre of Europe and with one of the best rail networks in the world, the STCC is easily accessible by train.

| Route Option                                   | How it Works  | Duration                       | Changes | Best For                     | Notes   |
|--|---|--------------------------------|---------|------------------------------|---|
| <b>Metro (M2 + M1)</b> ★<br><i>Most common</i> | Take M2 from Lausanne Gare - change at Flon - take M1 to EPFL | ~20 min                        | 1       | Fast, reliable daily commute | Most popular route; frequent service            |
| <b>Train + Metro (via Renens)</b>              | Train Lausanne -> Renens - M1 metro to EPFL                   | ~15-20 min                     | 1       | Fast if near train station   | Short metro ride (~6 min from Renens)           |
| <b>Direct Bus (tl 1)</b>                       | Bus line 1 from Lausanne Gare - EPFL (Colladon terminus)      | ~25 min                        | 0       | Simple, no transfers         | Only runs weekdays during the day               |
| <b>By Car</b>                                  | Drive via A1 motorway (Lausanne-Sud -> EPFL exit)             | ~15-25 min (traffic dependent) | 0       | Convenience / off-hours      | Parking available but limited during peak times |

## Parking on EPFL Campus if traveling by Car

**Parking EPFL - SwissTech Village**

**P** PARKING  
EPFL - SWISSTECH VILLAGE

STCC

0' ON FOOT +2'

The SwissTech Convention Center is a 2 minutes' walk away.

**Parking details**

- 220 places
- 4.- CHF per hour
- Unlimited duration
- Rue Louis-Favre, 1024 Ecublens

---

**Parking EPFL Campus car park**

**P** PARKING  
EPFL CAMPUS CAR PARK

STCC

0' ON FOOT +6'

**Parking details**

- 150 places
- 30.- CHF per day
- Unlimited duration
- Route Cantonale - Avenue Farel  
Lausanne

## Alternative parking in the area

**Parking P+R Bourdonnette**

**P** PARKING  
P+R BOURDONNETTE

EPFL

0' M1 +5'

The metro station is on the other side of the road. Take the subway M1 direction to Renens-Gare and get off at « EPFL » stop.

**Parking details**

- 250 places
- 15.- CHF per day
- 1 day duration
- Route de Chavannes 17  
Lausanne

## 7. Weather in Lausanne (April 2026)

|                 |   |
|-----------------|---|
| <b>April 20</b> | <b>-Temperature:</b> High:14°C / Low:5°C<br><b>-Weather:</b> Mostly cloudy with possible light rain. Cool spring conditions with moderate humidity. |
| <b>April 21</b> | <b>-Temperature:</b> High:15°C / Low:6°C<br><b>-Weather:</b> Partly sunny with scattered clouds. Mild daytime temperatures typical of late April.   |
| <b>April 22</b> | <b>-Temperature:</b> High:15°C / Low:6°C<br><b>-Weather:</b> Mix of sun and clouds with a slight chance of showers.                                 |

These conditions are typical for late April around Lake Geneva, where weather can shift quickly between sun and light rain, so a light jacket and layers are recommended. Check latest forecasts here:

<https://www.meteoswiss.admin.ch>

## 8. General Information

View the summit's **programme** here: <https://sustainable-construction.org/programme/>

- **On arrival - Day 1 (20 April)** Registration and badge pick-up opens at 7:30 at the SwissTech Convention Center.
- You will receive an email this week from [support@weezevent.com](mailto:support@weezevent.com) with details on **badge collection** and on-site check-in (kindly check your spam folder if you have not received it in your inbox).

**Electricity Plug type:** Switzerland primarily uses **Type J (3-pin, grounded)** and **Type C (2-pin, Europlug)** sockets. While Type C plugs fit into Type J outlets, a **specific Swiss 3-pin adapter** is required for grounded devices. Type J sockets have three, round, recessed holes arranged in a slight hexagon.



(At the Starling hotel, the plugs available are compatible with all types of plug worldwide, EU, USA and more).

| Currency          | Time zone  | Emergency contacts  |
|-------------------|--|---|
| Swiss Franc (CHF) | Central European Summer Time ( <b>CEST</b> , UTC +2), by April | Police: <b>117</b><br>Ambulance: <b>144</b><br>Fire-related incidents: <b>118</b> |

## 9. Security protocol

- In the event of an emergency, participants are advised to immediately contact the Swiss police by dialling **117**. For medical emergencies, please dial **144**, and for fire-related incidents, dial **118**.
- To ensure a safe and secure environment throughout the Sustainable Buildings Summit in Lausanne, we kindly ask all participants to remain vigilant and follow any instructions provided by venue staff or event organisers. Please keep your personal belongings secure at all times and wear your event badge visibly within the conference premises. Additionally, there will also be a cloakroom, on **level minus one**, available for you to store your belongings.

- If you encounter any issues, security concerns, or require assistance during the summit, do not hesitate to contact members of the organising team: [nazik.ashyrova@un.org](mailto:nazik.ashyrova@un.org) and [clement.charnaillat@un.org](mailto:clement.charnaillat@un.org)
- Our team will be available throughout the event to support you and help ensure a smooth and safe experience for all participants.

## 10. Important Note for Funded Participants Only:

- Kindly note that 100% of your DSA, visa expenses, and self-ticketed travel costs will be reimbursed after the event via bank transfer, upon receipt of all boarding passes. If you have not yet done so, please send your bank details to [nazik.ashyrova@un.org](mailto:nazik.ashyrova@un.org) and [global.abc@un.org](mailto:global.abc@un.org) in copy.
- If you have receipts for self-ticketed travel and visa expenses, please also share these with [nazik.ashyrova@un.org](mailto:nazik.ashyrova@un.org) and [global.abc@un.org](mailto:global.abc@un.org) in copy.
- As indicated on your ticket, please ensure that you check in for your train at least 72 hours prior to departure. You may do so here: <https://check-in.accesrail.com/#/step1>.